

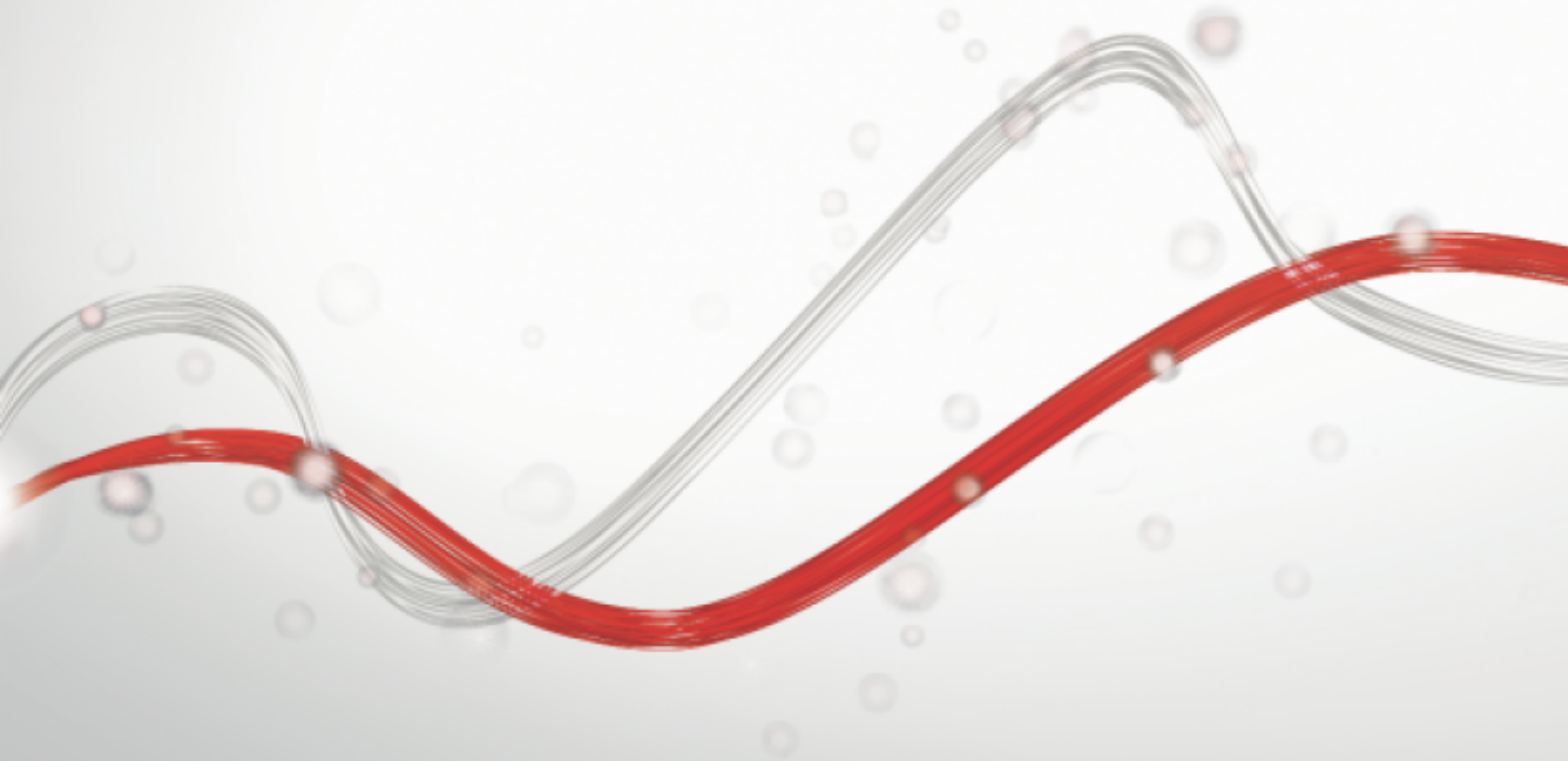

Be ahead

P7 / P4,5





## Hydraulic automation systems for swing gates

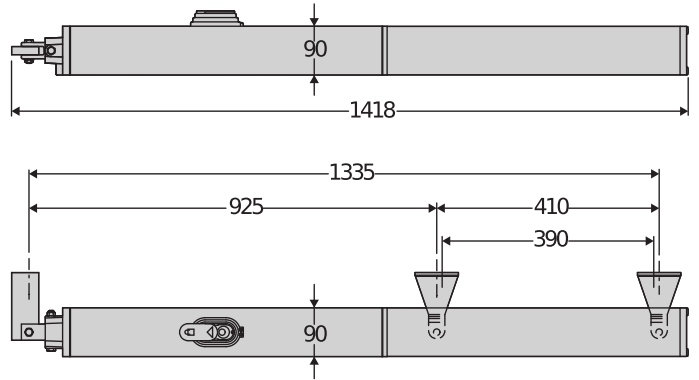

Extremely sturdy and reliable hydraulic operators for industrial and condominium use. They can automate swing gate leaves up to 7m wide and weighing up to 500kg. Smooth, silent gate movements are guaranteed by the extremely high-performance hydraulic system and the closing slowdown. Maximum precision in traction and thrust force control is guaranteed by the by-pass valve system.

### Relevant features



The rear articulated brackets and jointed rod make installation simple and reliable in all situations.



The brass release knob, protected with a personal key, facilitates the manual opening of the gate in the event of a power cut.



The closing slowdown guarantees silent, smooth movements on even the biggest gates. Also, the adjustment screw makes it possible to adapt the slowdown intensity to needs of each situation.





## Hydraulic automation systems for swing gates

### P7 / P4,5

| Code          | Name        | Description  |
|---------------|-------------|--|
| P935061 00001 | P4,5        | Reversible hydraulic operator for swing gates up to 4.5 m. 500 kg in weight. Cycle time 28+slowdown s. Useful travel 390 mm. max angle 123 °. Closing slowdown           |
| P935061 00004 | P4,5 WINTER | Reversible hydraulic operator for swing gates up to 4.5 m. 500 kg in weight. Cycle time 28+slowdown s. Useful travel 390 mm. max angle 123 °. Extremely low temperatures |
| P935061 00003 | P4.5 UL/CSA | Reversible hydraulic operator for swing gates up to 4.5 m. 500 kg in weight. Cycle time 28+slowdown s. Useful travel 390 mm. max angle 123 °. Closing slowdown           |
| P935060 00001 | P7          | Reversible hydraulic operator for swing gates up to 7 m. 500 kg in weight. Cycle time 42+slowdown s. Useful travel 390 mm. max angle 123 °. Closing slowdown             |
| P935060 00004 | P7 WINTER   | Reversible hydraulic operator for swing gates up to 7 m. 500 kg in weight. Cycle time 42+slowdown s. Useful travel 390 mm. max angle 123 °. Extremely low temperatures   |
| P935060 00003 | P7 UL/CSA   | Reversible hydraulic operator for swing gates up to 7 m. 500 kg in weight. Cycle time 42+slowdown s. Useful travel 390 mm. max angle 123 °. Closing slowdown             |

#### RIGEL 6 220-230V 50/60HZ: Universal control panel with display for one or two 230V - 650+650W operators



##### D113833 00002 - RIGEL 6 220-230V 50/60HZ - Recommended









- Universal control panel with display for one or two 230V - 650+650W operators
- Application: universal control panel for one or two operators
- Card power supply: 230 V single-phase
- Operators power supply: 230V single-phase 600+600W
- Main features: removable terminal blocks, programming and diagnostics with display, built-in four-channel receiver, electro lock, electronic torque limiter, electronic deceleration at opening and closing, a separate limit switch inputs for each motor, traffic light management, preheating hydraulic operators, weekly timer, possibility to delete a specific remote control, customization of the 4 radio channels, personalization of the duration of the delayed output, adjustable sensitivity to the obstacle.
- Main functions: automatic re-closing, separate motor working times, stays locked when closed, water hammer, 2/3/4 step logic, partial opening, fast closing, separate opening and closing
- Compatibility: RIGEL 5 - RIGEL 4 - RIGEL 3 - RIGEL N

|                               | P4,5             | P4,5 WINTER      | P4.5 UL/CSA      | P7               | P7 WINTER        | P7 UL/CSA        |
|-------------------------------|------------------|------------------|------------------|------------------|------------------|------------------|
| Control unit                  | RIGEL 6          | RIGEL 6          | RIGEL 6          | RIGEL 6          | RIGEL 6          | RIGEL 6          |
| Board power supply            | 230 V            | V                | V                | 230 V            | 230 V            | 230 V            |
| Motor voltage                 | 230 V            | 230 V            | 120 V            | 230 V            | 230 V            | 120 V            |
| Power consumption             | 250 W            | 250 W            | 250 W            | 250 W            | 250 W            | 250 W            |
| Max. width of door/gate wing  | 4,50 m           | 4,50 m           | 4,50 m           | 7 m              | 7 m              | 7 m              |
| Max. weight of door/gate wing | 500 kg           | 500 kg           | 500 kg           | 500 kg           | 500 kg           | 500 kg           |
| Useful rod stroke             | 390 mm           | 390 mm           | 390 mm           | 390 mm           | 390 mm           | 390 mm           |
| Maximum angle                 | 123 °            | 123 °            | 123 °            | 123 °            | 123 °            | 123 °            |
| Cycle time                    | 28+slowdown s    | 28+slowdown s    | 28+slowdown s    | 42+slowdown s    | 42+slowdown s    | 42+slowdown s    |
| Type of limit switch          | work time        | work time        | work time        | work time        | work time        | work time        |
| Slowdown                      | During closing   | During closing   | During closing   | During closing   | During closing   | During closing   |
| Locking                       | Solenoid Lock    | Solenoid Lock    | Solenoid Lock    | Solenoid Lock    | Solenoid Lock    | Solenoid Lock    |
| Release                       | Reversible       | Reversible       | Reversible       | Reversible       | Reversible       | Reversible       |
| Impact reaction               | Hydraulic clutch | Hydraulic clutch | Hydraulic clutch | Hydraulic clutch | Hydraulic clutch | Hydraulic clutch |
| Frequency of use              | very intensive   | very intensive   | very intensive   | very intensive   | very intensive   | very intensive   |
| Protection rating             | IP55             | IP55             | IP55             | IP55             | IP55             | IP55             |
| Environmental conditions      | -10 + 60 °C      | -30 + 60 °C      | -10 + 60 °C      | -10 + 60 °C      | -30 + 60 °C      | -10 + 60 °C      |



## Hydraulic automation systems for swing gates

### RECOMMENDED ACCESSORIES

|   |  |   |  |
|---|--|---|--|
|   | <p><b>new</b> D114092 00002 - <b>ALCOR AC A</b></p> <p>Control unit with on-board receiver - no display - Standard terminal block</p>                        |  | <p>N999131 - <b>NAT</b></p> <p>Adapter for 230V hydraulic operators for inserting the spiral cable protection sheath</p>                           |
|  | <p>D610180 - <b>CLS</b></p> <p>Triangular release key l=52 mm</p>  |  | <p>D111013 - <b>ME</b></p> <p>Control board for 12Vac solenoid lock for 230V automation systems</p>  |
|   | <p><b>new</b> P111782 - <b>COMPACTA A20-180</b></p> <p>Pair of photocells adjustable 180 ° horizontally. Range 20m. Power supply 12 – 33Vac / 15 – 35Vdc</p> |  | <p><b>new</b> D114094 00002 - <b>RADIUS LED AC A R0</b></p> <p>Flashing light without incorporated antenna for motors with power supply 230 V.</p> |
|  | <p><b>new</b> D114093 00002 - <b>RADIUS LED AC A R1</b></p> <p>Flashing light with incorporated antenna for motors with power supply 230 V.</p>              |   |  |





## Hydraulic automation systems for swing gates

# What is U-Link?

The technology that gives you more power

U-Link, Universal Link, is an exclusive BFT platform that can be used to create high-tech ecosystems. In Home Access Automation, it can be used to communicate with all home access automation devices of any brand. This saves you time and allows you to control everything easily and without any worries.

### It is intuitive

Easy to install and to use

### It is scalable

You can add as many devices as you want

### It is flexible

It allows you to create groups of interconnected products

### It is practical

Works with or without an internet connection

### It is functional

Its settings can be controlled remotely using dedicated applications



## Hydraulic automation systems for swing gates

# Everything on one screen: find out more about this amazing technology

A world-exclusive platform that **can be used to create high-tech ecosystems** offering a vast range of solutions for many different sectors.

This proprietary platform which is a key feature of BFT products, thanks to the B-EBA cards and the Clonix U-Link receiver, is suitable for any protocol or product for access automation (including BFT products non-BFT ones and older versions) and it can be used in a variety of different sectors. This means any device becomes a smart device which can be interconnected with other systems, using a language that is becoming universal.



### U-Control HOME

U-Control HOME is the application that allows you to open the gate to your home and to remotely control BFT automations using your own smartphone. The iOS version can be used to automatically open the automation when you are close to it.



### U-Base 2

A software package for installation, performing maintenance and identifying any faults in the U-Link compatible operators, easily and conveniently.



### U-SDK

U-SDK is the application which allows BFT automations to be made compatible and easily integrated with a BMS network.



### Clonix U-Link

Connect non-native U-Link and non-BFT products to U-Link systems.

Is it possible to connect non-native U-Link BFT operators or other brands of products to U-Link? Yes, thanks to the Clonix receivers. Accessories which accept no limits.



### B-EBA

A direct link to your operators.

The B-EBA expansion cards make it possible to connect external devices such as PCs, smartphones and tablets to a BFT operator and a Clonix receiver or to connect multiple BFT products in a U-Link network. These accessories integrate with U-Link technology and with Bluetooth, Wifi, Z-Wave and TCP/IP protocols as well as with the RS485 serial interface. A device that demonstrates exactly what BFT means by interconnectivity.

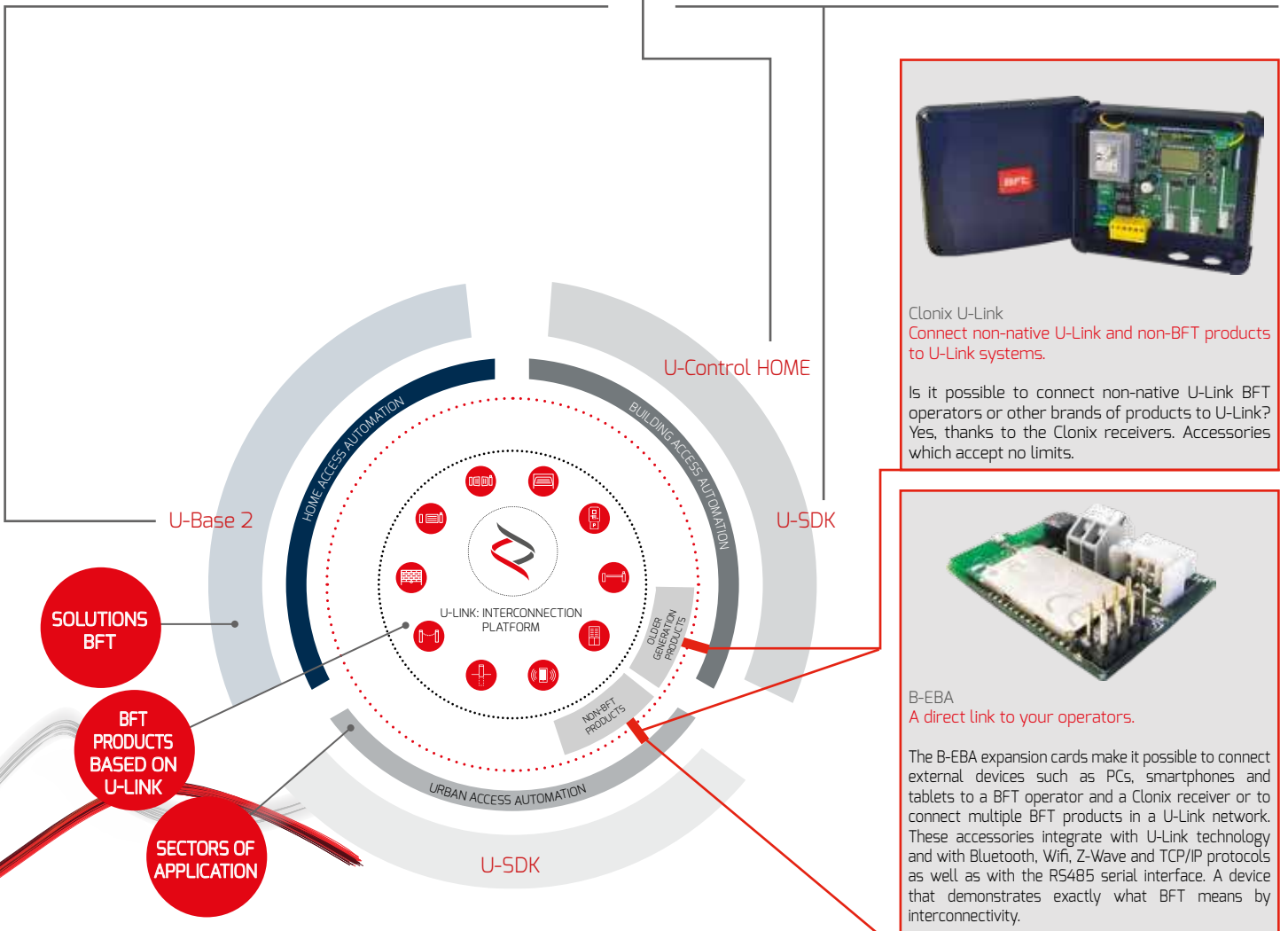



INFORMATION REGARDING THE PROTECTION OF THE INDUSTRIAL AND INTELLECTUAL PROPERTY RIGHTS OF BFT. BFT S.p.A. protects its industrial property by depositing trademarks, patents, models and designs. The intellectual property of BFT S.p.A. is protected by copyright law. BFT S.p.A. also protects its know-how by taking measures to protect the technical and commercial information inherent in its company and products. All the products in this catalogue are ORIGINAL BFT MODELS and only BFT S.p.A. is authorised to produce them and market them anywhere in the world. All the commercial names in this catalogue are owned by BFT S.p.A., and only BFT S.p.A. is authorised to use them in relation to the corresponding merchandise category. FALSIFIERS WILL BE PROCEEDED AGAINST IN ACCORDANCE WITH BOTH CIVIL AND CRIMINAL LAW. THESE CONDITIONS NOT ONLY GUARANTEE THE INTELLECTUAL PROPERTY RIGHTS OF BFT, BUT ALSO PROTECT CUSTOMERS BY GUARANTEEING THAT THE PRODUCTS THEY ARE PURCHASING ARE ORIGINAL BFT PRODUCTS RESULTING FROM STUDIES AND DESIGNS WITHIN THE BFT COMPANY.